

ITEM 14

CITY OF WOLLONGONG TRAFFIC COMMITTEE - MINUTES OF MEETING HELD 8 AUGUST 2018

The City of Wollongong Traffic Committee meeting was held on 8 August 2018. Items 1 – 4 and 6 – 13 are to be adopted by Council through delegated authority. Item 5 must be determined by Council and is recommended to Council for approval for the temporary Regulation of Traffic on public roads for works or events by independent parties.

RECOMMENDATION

In accordance with the powers delegated to Council, the Minutes and recommendations of the City of Wollongong Traffic Committee held on 8 August 2018 in relation to Regulation of Traffic be adopted.

REPORT AUTHORISATIONS

Report of: Martin Parmenter, Building and Facilities Planning Manager
Authorised by: Glenn Whittaker, Manager Project Delivery

ATTACHMENTS

- 1 Standard Conditions for Road Closures
- 2 McCauley Street Road Closure

BACKGROUND

5 THIRROUL – WARD 1

McCauley Street – Changed from 15 August to 20 September 2018

Background:

A builder has applied for a road closure on Wednesday, 20 September 2018 between 3 am and 7 pm in McCauley Street Thirroul, at house No. 32 (opposite Harbord Street). The attached TMP requires a detour around the site via Bath or Ocean Street, Cliff Parade, Spray Street, Ann Street, Station Street and Raymond Road. It will be desirable for advance warning to be given by way of two VMS boards on McCauley Street 7 days before the closure. The work will involve a large crane under a special vehicle permit, and which will need to be assembled on site.

The building units will be delivered by over width/over length vehicles and for these reasons it is necessary to remove parking from both sides of McCauley Street at the intersection with Lawrence Hargrave Drive. Similarly, parking will need to be removed at the corners of McCauley and Ocean Streets, Ocean Street and Cliff Parade.

The trucks and crane involved require the width of McCauley Street to be occupied for the period of the closure and residents will be advised that only limited vehicle access will be available during the closure. This item is a resubmission due to the change of date previously approved for 15 August.

Consultation:

Consultation with affected residents is a requirement for this Agenda item.

PROPOSAL SUPPORTED UNANIMOUSLY

The proposed road closure be approved subject to the submitted Traffic Management Plan Attachment 2) and Council's Standard Conditions for Road Closures (Attachment 1), the use of two Variable Message boards in McCauley Street 7 days in advance of the closure to advise of the work, and that consultations be held with those business operators and home owners affected by the closure and the loss of street parking.

PLANNING AND POLICY IMPACT

This report contributes to the delivery of Our Wollongong 2028 goal - *We have affordable and accessible transport.*

It specifically delivers on core business activities as detailed in the Draft Service Plan 2018-19.

Attachment 1 – WCC Standard Conditions

Standard Conditions for Road Closures

For Special Events and Work Related activities Within Council Road Reserves.

Following approval by Wollongong City Council, road closures are subject to the additional Council conditions:

1. **The Applicant must complete the Council form** 'Application to Open and Occupy or Underbore a Roadway or Footpath' (Refer to Checklist below – relates to Section 138 of the Roads Act.)
2. **NSW Police Approval:** The Applicant must obtain written approval from NSW Police, where required under the Roads Act.
3. **If the Road Closure is within 100m of any traffic control signals or on a 'State Classified Road'** the Applicant must obtain a Road Occupancy Licence (ROL) from NSW Roads & Maritime Services (RMS).
4. **The Applicant must advise all affected residents and business owners** within the closure area of the date/s and times for the closure, at least 7 days prior to the intended date of works.
5. **The Applicant must advise Emergency Services:** Ambulance, Fire Brigade and Police, Taxi and Bus Companies of the closure dates and times in writing, 7 days prior to the intended date of works. The Applicant must endeavour to minimise the impact on bus services during the closure.
6. **Traffic Management Plan:** The closure must be set up in accordance with the approved **Traffic Management Plan (TMP)** prepared by an appropriately qualified traffic controller; a copy of whose qualifications must be included with the submitted TMP.
7. **Traffic Management Plan Setup:** The Traffic Management Plan must be set up by appropriately qualified traffic control persons or the NSW Police.
8. **Access to properties affected by the road closure must be maintained where possible.** Where direct access cannot be achieved, an alternative arrangement must be agreed to by both the applicant and the affected person/s.
9. **Public Notice Advertisement:** The Applicant must advertise the road closure in the Public Notices section of the local paper, detailing closure date/s and times at least 7 days prior to the closure.
10. **Public Liability Policy:** The Applicant must provide Council with a copy of their current insurance policy to a value of no less than \$20 million dollars to cover Wollongong City Council from any claims arising from the closure.

Checklist:

- Completed Council Form:**
'Application to Open and Occupy or Underbore a Roadway or Footpath'.

Required information as shown below MUST be attached:

- A copy of the letter from the Traffic Committee authorising the closure
 The Traffic Management Plan (TMP)
 The Road Occupancy Licence (ROL) *if required*
 Written approval from NSW Police
 Public Liability Insurance

Applications may be lodged in the Customer Service Centre located on the Ground Floor of Council's Administration Building, 41 Burelli Street Wollongong between 8.30am and 5pm Monday to Friday.

Z16/135267

McCauley St, Thirroul

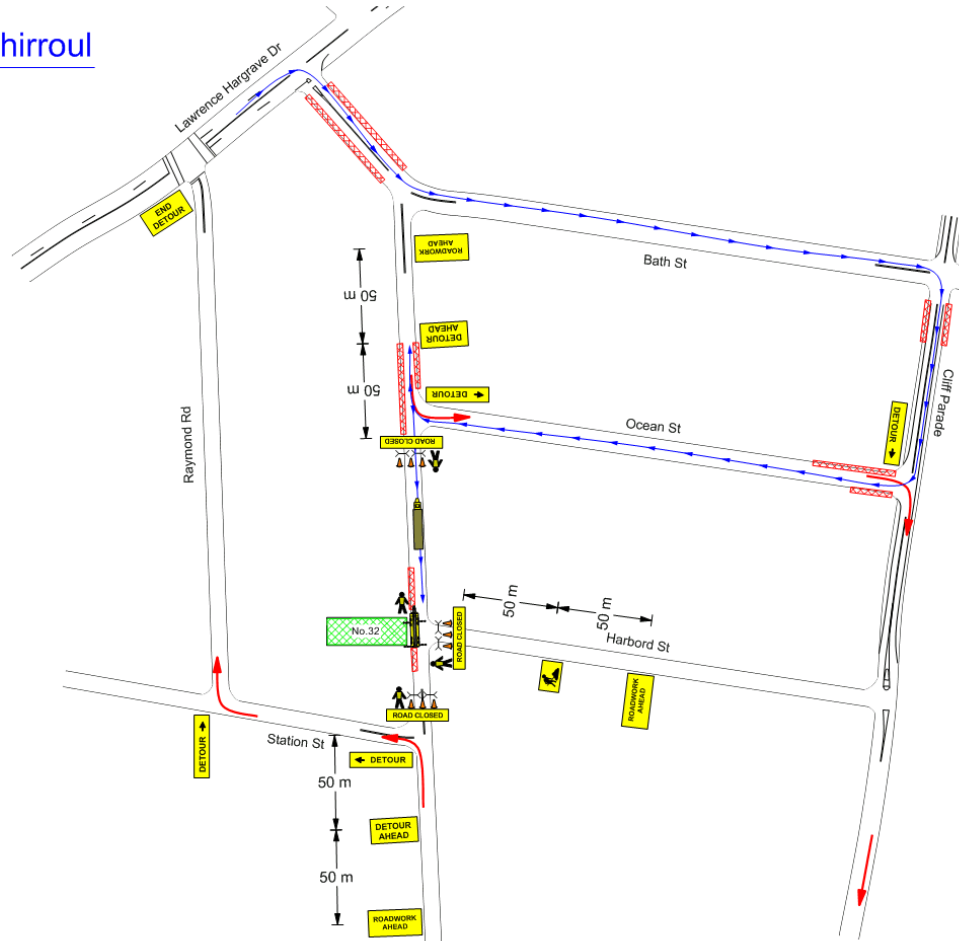

Legend	
	Cone
	Parking Prevention Areas
	Truck Route
	Work Area

For works on and around footpath a minimum width of 1.5m shall be maintained at all times for pedestrians to pass unhindered

Pedestrians shall not be directed onto roadway unless traffic controllers are used to control site and proper measures are put in place to conform with AS 1742.3

For any stop/slow works setup signs and distances in relation traffic controllers as illustrated here.

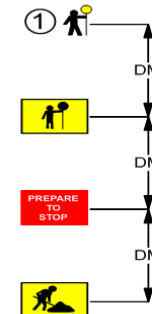

Client: Nunn Bros Haulage
Location: McCauley St, Thirroul
TcP No: TLTCP AS-32649
REV: A
Scope Of Works: Crane Works
TcP(s) Used as a Guide: XXXX
TcP Designed Date: 26.7.18
TcP Expire Date: 26.7.20

Designed by: Matthew Jones
Cen No: 0033239263
Signature:

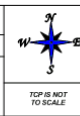

Approximate speed of traffic at beginning of taper	Traffic control taper	Warning taper	Advance taper	D - THE SPEED OF TRAFFIC MEASURED IN KI/HR
45 or less	15	0	15	500M - 50M
46 - 55	15	15	30	REG: 700M - 70M
56 - 65	30	30	60	REG: 400M - 60M
66 - 75	N/A	75	115	REG: 500M - 50M
76 - 85	N/A	80	130	REG: 700M - 70M
86 - 95	N/A	90	145	REG: 800M - 80M
96 - 105	N/A	100	160	REG: 900M - 90M
106 or less	N/A	110	175	REG: 1000M - 100M

Implemented By
Name -
Cart No -
Date -
Signed -

This TcP is to be setup and packed up by qualified traffic controllers with minimum current Implement Traffic Control Plans (Yellow Card). Any modifications to this TcP is to be made by qualified personnel. All modifications to be signed off on this TcP along with certification number